

**Support 280x240**

|                                  |                        |
|----------------------------------|------------------------|
| WB 1 PB                          |                        |
| Angle drilling- and milling head | S1 143 12              |
| <i>Winkel-Bohr- und Fräskopf</i> |                        |
| max. power on drive              | 30 kW                  |
| <i>Max. Leistung (S1)</i>        |                        |
| max. spindle torque              | 1400Nm                 |
| <i>Max. Spindeldrehmoment</i>    |                        |
| max. spindle speed               | 3150 rpm               |
| <i>Max. Drehzahl</i>             |                        |
| tool clamping                    | automatic              |
| <i>Werkzeugspannung</i>          | <i>automatisch</i>     |
| possible tools                   | SK50                   |
| <i>Werkzeugaufnahme</i>          |                        |
| coolant supply                   | internal / external    |
| <i>Kühlmittelezufuhr</i>         | <i>innere / äußere</i> |

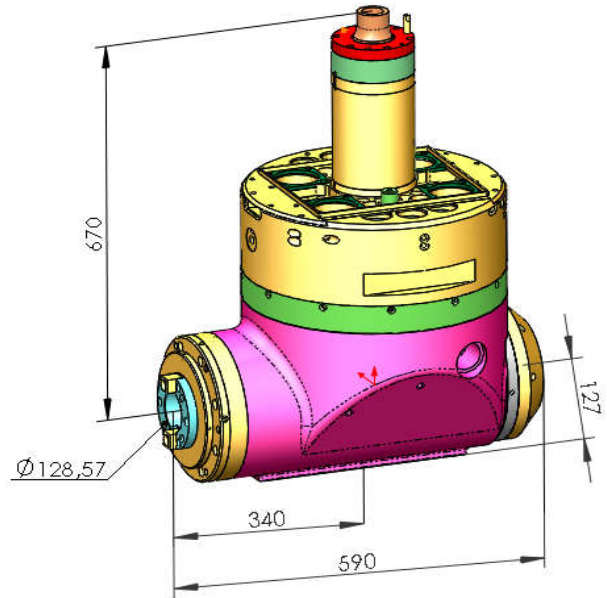

|                                     |                        |
|-------------------------------------|------------------------|
| GB 1 B                              |                        |
| Straight drilling- and milling head | S1 090 12              |
| <i>Gerader Bohr- und Fräskopf</i>   |                        |
| max. power on drive                 | 52 kW                  |
| <i>Max. Leistung (S1)</i>           |                        |
| max. spindle torque                 | 2400Nm                 |
| <i>Max. Spindeldrehmoment</i>       |                        |
| max. spindle speed                  | 3150 rpm               |
| <i>Max. Drehzahl</i>                |                        |
| tool clamping                       | automatic              |
| <i>Werkzeugspannung</i>             | <i>automatisch</i>     |
| possible tools                      | SK50                   |
| <i>Werkzeugaufnahme</i>             |                        |
| coolant supply                      | internal / external    |
| <i>Kühlmittelezufuhr</i>            | <i>innere / äußere</i> |

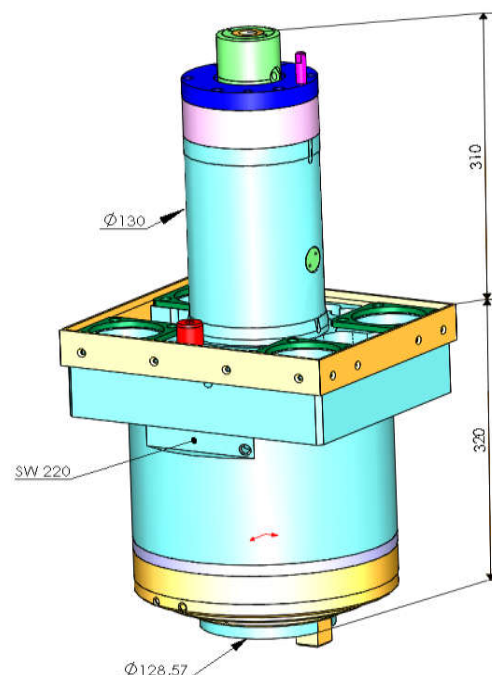

**Support 280x240**

-tool adaption: 1x horizontal Capto C8

-Werkzeugaufnahme: 1x horizontal Capto C8

|                          |                        |
|--------------------------|------------------------|
| DMH HC8                  |                        |
| Turning tool holder      | S3 313 52              |
| <i>Drehmeißelhalter</i>  |                        |
| -max. cutting force      | 36kN                   |
| <i>Max. Schnittkraft</i> |                        |
| tool clamping            | automatic              |
| <i>Werkzeugspannung</i>  | <i>automatisch</i>     |
| coolant supply           | internal / external    |
| <i>Kühlmittelzufuhr</i>  | <i>innere / äußere</i> |

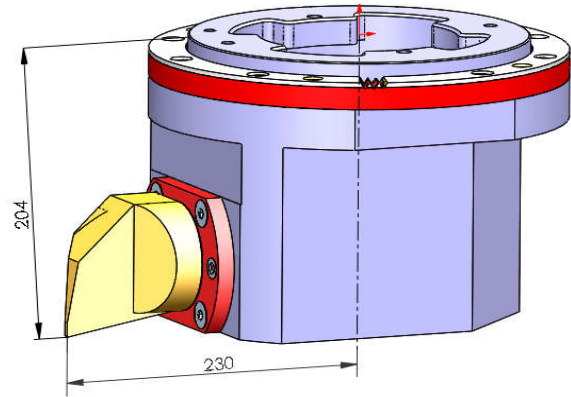

-tool adaption: 1x vertical Capto C8

-Werkzeugaufnahme: 1x vertikal Capto C8

|                          |                        |
|--------------------------|------------------------|
| DMH VC8                  |                        |
| Turning tool holder      | S3 314 52              |
| <i>Drehmeißelhalter</i>  |                        |
| -max. cutting force      | 36kN                   |
| <i>Max. Schnittkraft</i> |                        |
| tool clamping            | automatic              |
| <i>Werkzeugspannung</i>  | <i>automatisch</i>     |
| coolant supply           | internal / external    |
| <i>Kühlmittelzufuhr</i>  | <i>innere / äußere</i> |

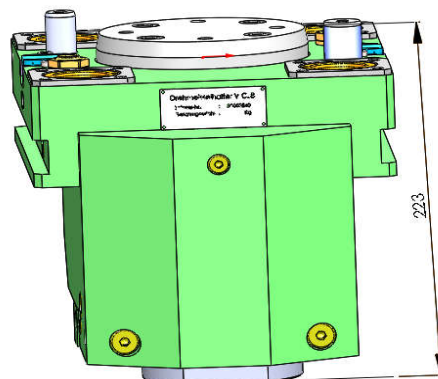

**Support 280x240**

|  |                        |
|--|------------------------|
| <b>GB 1 XB</b>                             |                        |
| <b>Straight drilling- and milling head</b> | S1 182 12              |
| <b>Gerader Bohr- und Fräskopf</b>          |                        |
| max. power on drive                        | 25 kW                  |
| <i>Max. Leistung (S1)</i>                  |                        |
| max. spindle torque                        | 500Nm                  |
| <i>Max. Spindeldrehmoment</i>              |                        |
| max. spindle speed                         | 3150 rpm               |
| <i>Max. Drehzahl</i>                       |                        |
| tool clamping                              | automatic              |
| <i>Werkzeugspannung</i>                    | <i>automatisch</i>     |
| possible tools                             | SK50                   |
| <i>Werkzeugaufnahme</i>                    |                        |
| coolant supply                             | internal / external    |
| <i>Kühlmittelezufuhr</i>                   | <i>innere / äußere</i> |

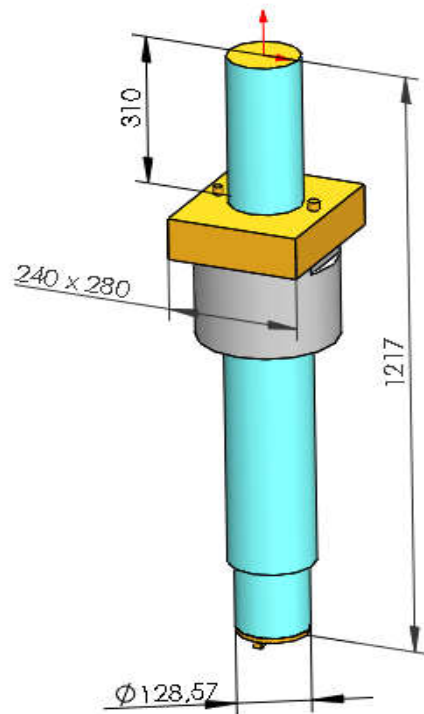

|  |                        |
|--|------------------------|
| <b>UB 05 B</b>                             |                        |
| <b>Universal drilling and milling head</b> | S1 461 12              |
| <b>Universal-Bohr- und Fräskopf</b>        |                        |
| max. power on drive                        | 30 kW                  |
| <i>Max. Leistung (S1)</i>                  |                        |
| max. spindle torque                        | 400Nm                  |
| <i>Max. Spindeldrehmoment</i>              |                        |
| max. spindle speed                         | 4000 rpm               |
| <i>Max. Drehzahl</i>                       |                        |
| tool clamping                              | automatic              |
| <i>Werkzeugspannung</i>                    | <i>automatisch</i>     |
| possible tools                             | SK50                   |
| <i>Werkzeugaufnahme</i>                    |                        |
| coolant supply                             | internal / external    |
| <i>Kühlmittelezufuhr</i>                   | <i>innere / äußere</i> |

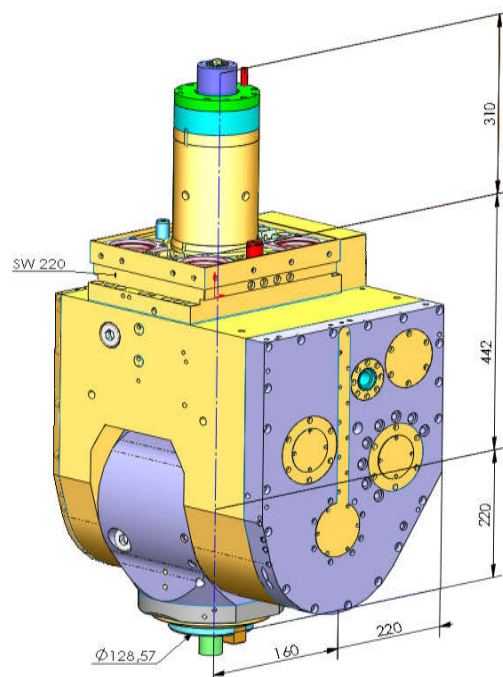

**Support 420x340**

|                                  |                        |
|----------------------------------|------------------------|
| WB 1 PB                          |                        |
| Angle drilling- and milling head | S1 678 14              |
| <i>Winkel-Bohr- und Fräskopf</i> |                        |
| max. power on drive              | 52 kW                  |
| <i>Max. Leistung (S1)</i>        |                        |
| max. spindle torque              | 2400Nm                 |
| <i>Max. Spindeldrehmoment</i>    |                        |
| max. spindle speed               | 3150 rpm               |
| <i>Max. Drehzahl</i>             |                        |
| tool clamping                    | automatic              |
| <i>Werkzeugspannung</i>          | <i>automatisch</i>     |
| possible tools                   | SK50                   |
| <i>Werkzeugaufnahme</i>          |                        |
| coolant supply                   | internal / external    |
| <i>Kühlmittelzufuhr</i>          | <i>innere / äußere</i> |

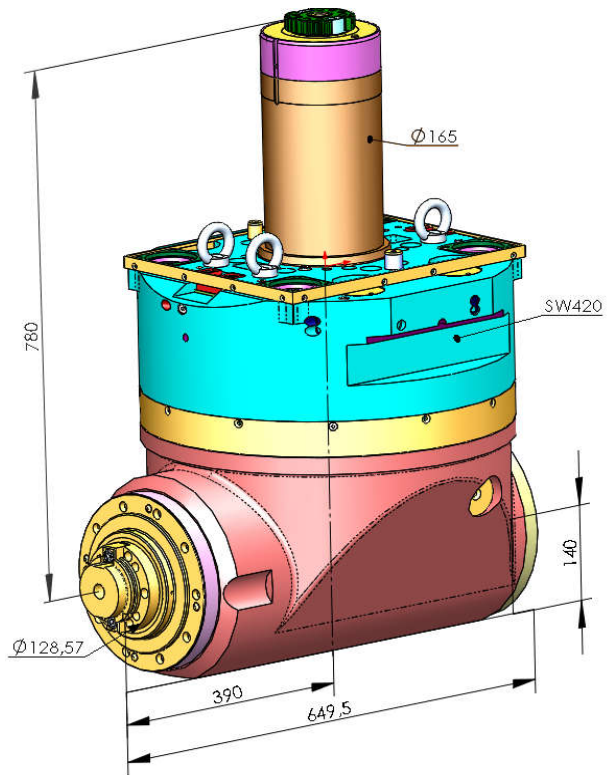

|                                     |                        |
|-------------------------------------|------------------------|
| GB 1 B                              |                        |
| Straight drilling- and milling head | S1 677 14              |
| <i>Gerader Bohr- und Fräskopf</i>   |                        |
| max. power on drive                 | 52 kW                  |
| <i>Max. Leistung (S1)</i>           |                        |
| max. spindle torque                 | 2400Nm                 |
| <i>Max. Spindeldrehmoment</i>       |                        |
| max. spindle speed                  | 3150 rpm               |
| <i>Max. Drehzahl</i>                |                        |
| tool clamping                       | automatic              |
| <i>Werkzeugspannung</i>             | <i>automatisch</i>     |
| possible tools                      | SK50                   |
| <i>Werkzeugaufnahme</i>             |                        |
| coolant supply                      | internal / external    |
| <i>Kühlmittelzufuhr</i>             | <i>innere / äußere</i> |

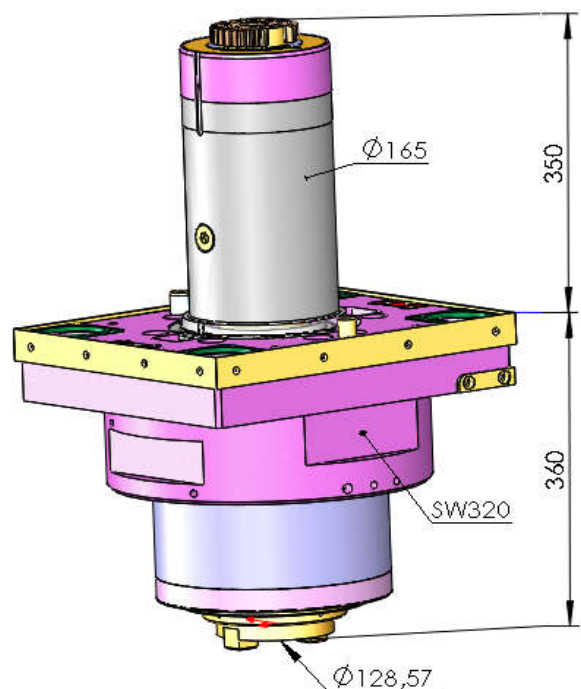

**Support 420x340**

-tool adaption: 1x horizontal HSK-A100 T

-Werkzeugaufnahme: 1x horizontal HSK-A100 T

|                          |                        |
|--------------------------|------------------------|
| DMH                      |                        |
| Turning tool holder      | S3 148 24              |
| <i>Drehmeißelhalter</i>  |                        |
| -max. cutting force      | 40kN                   |
| <i>Max. Schnittkraft</i> |                        |
| tool clamping            | automatic              |
| <i>Werkzeugspannung</i>  | <i>automatisch</i>     |
| coolant supply           | internal / external    |
| <i>Kühlmittelzufuhr</i>  | <i>innere / äußere</i> |

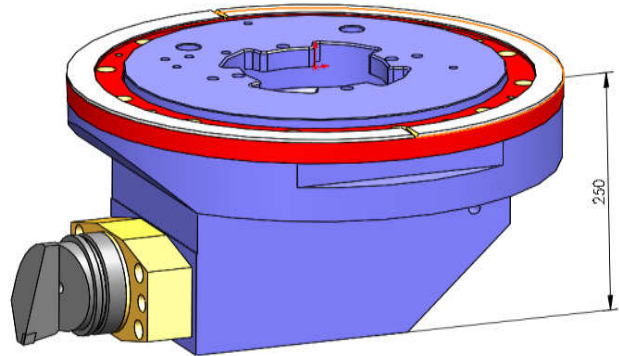

-tool adaption: 3x vertical / 3x horizontal Capto C8

*Werkzeugaufnahme: 3x vertikal / 3x horizontal Capto C8*

|                          |                        |
|--------------------------|------------------------|
| DMH                      |                        |
| Turning tool holder      | S3 134 54              |
| <i>Drehmeißelhalter</i>  |                        |
| -max. cutting force      | 55kN                   |
| <i>Max. Schnittkraft</i> |                        |
| tool clamping            | manual                 |
| <i>Werkzeugspannung</i>  | <i>manuell</i>         |
| coolant supply           | internal / external    |
| <i>Kühlmittelzufuhr</i>  | <i>innere / äußere</i> |

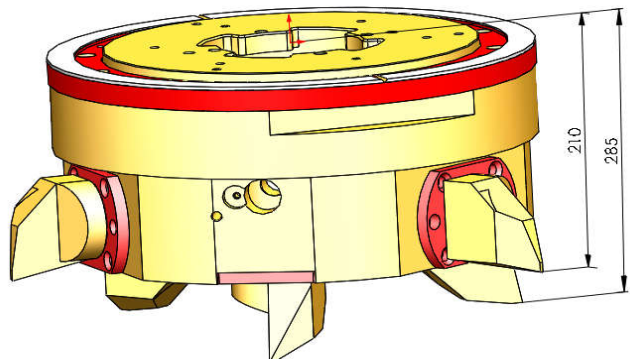

**Support 420x340**

|                                     |                        |
|-------------------------------------|------------------------|
| GB 1 XB                             |                        |
| Straight drilling- and milling head | S1 360 14              |
| <i>Gerader Bohr- und Fräskopf</i>   |                        |
| max. power on drive                 | 27 kW                  |
| <i>Max. Leistung (S1)</i>           |                        |
| max. spindle torque                 | 500Nm                  |
| <i>Max. Spindeldrehmoment</i>       |                        |
| max. spindle speed                  | 3150 rpm               |
| <i>Max. Drehzahl</i>                |                        |
| tool clamping                       | automatic              |
| <i>Werkzeugspannung</i>             | <i>automatisch</i>     |
| possible tools                      | SK50                   |
| <i>Werkzeugaufnahme</i>             |                        |
| coolant supply                      | internal / external    |
| <i>Kühlmittelzufuhr</i>             | <i>innere / äußere</i> |

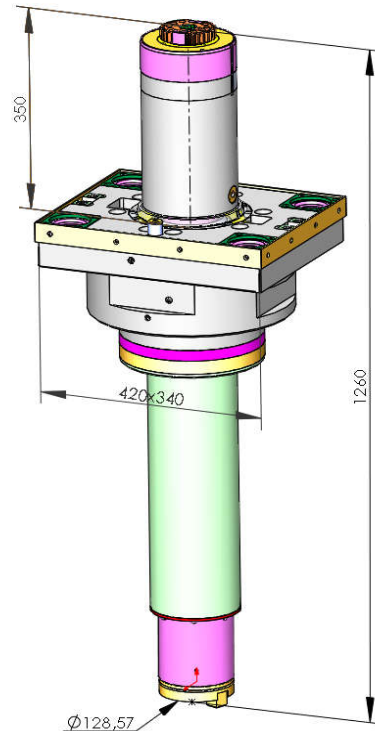

|                                      |                        |
|--------------------------------------|------------------------|
| UB 05 B                              |                        |
| Universal drilling- and milling head | S1 362 14              |
| <i>Universal-Bohr- und Fräskopf</i>  |                        |
| max. power on drive                  | 37 kW                  |
| <i>Max. Leistung (S1)</i>            |                        |
| max. spindle torque                  | 800Nm                  |
| <i>Max. Spindeldrehmoment</i>        |                        |
| max. spindle speed                   | 4000 rpm               |
| <i>Max. Drehzahl</i>                 |                        |
| tool clamping                        | automatic              |
| <i>Werkzeugspannung</i>              | <i>automatisch</i>     |
| possible tools                       | SK50                   |
| <i>Werkzeugaufnahme</i>              |                        |
| coolant supply                       | internal / external    |
| <i>Kühlmittelzufuhr</i>              | <i>innere / äußere</i> |

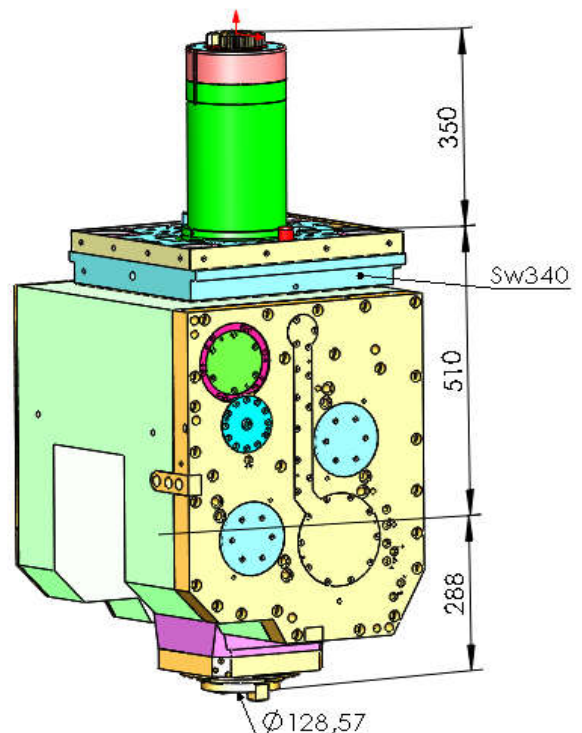

**Support 420x340**

-tool adaption: 1x vertical HSK-A100 T

-Werkzeugaufnahme: 1x vertikal HSK-A100 T

|                          |                        |
|--------------------------|------------------------|
| DMH VC8                  |                        |
| Turning tool holder      | S3 149 24              |
| <i>Drehmeißelhalter</i>  |                        |
| -max. cutting force      | 40kN                   |
| <i>Max. Schnittkraft</i> |                        |
| tool clamping            | automatic              |
| <i>Werkzeugspannung</i>  | <i>automatisch</i>     |
| coolant supply           | internal / external    |
| <i>Kühlmittelzufuhr</i>  | <i>innere / äußere</i> |

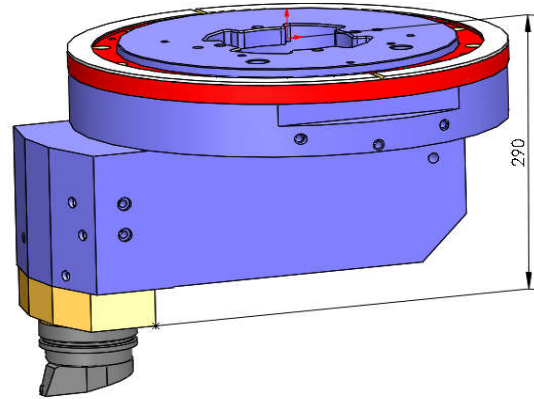

|                          |                |
|--------------------------|----------------|
| NSH                      |                |
| Standard tool holder     | S3 136 04      |
| <i>Normalstahlhalter</i> |                |
| max. cutting force       | 50kN           |
| <i>Max. Schnittkraft</i> |                |
| tool clamping            | manual         |
| <i>Werkzeugspannung</i>  | <i>manuell</i> |
| coolant supply           | external       |
| <i>Kühlmittelzufuhr</i>  | <i>äußere</i>  |

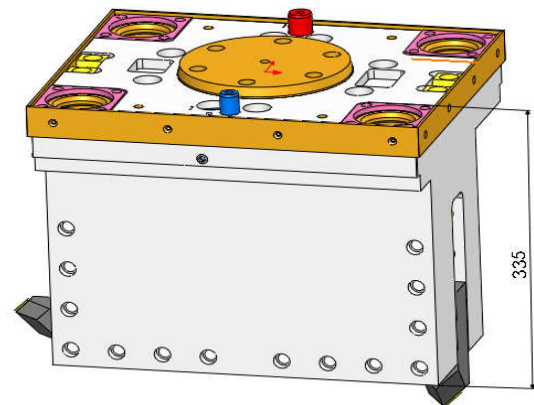

Support  $\varnothing 560 / 640 \times 570$

|                                  |                        |
|----------------------------------|------------------------|
| WB 1 N                           |                        |
| Angle drilling- and milling head | S1 669 67              |
| <i>Winkel-Bohr- und Fräskopf</i> |                        |
| max. power on drive              | 100 kW                 |
| <i>Max. Leistung (S1)</i>        |                        |
| max. spindle torque              | 8000Nm                 |
| <i>Max. Spindeldrehmoment</i>    |                        |
| max. spindle speed               | 2000 rpm               |
| <i>Max. Drehzahl</i>             |                        |
| tool clamping                    | automatic              |
| <i>Werkzeugspannung</i>          | <i>automatisch</i>     |
| possible tools                   | SK60                   |
| <i>Werkzeugaufnahme</i>          |                        |
| coolant supply                   | internal / external    |
| <i>Kühlmittelzufuhr</i>          | <i>innere / äußere</i> |

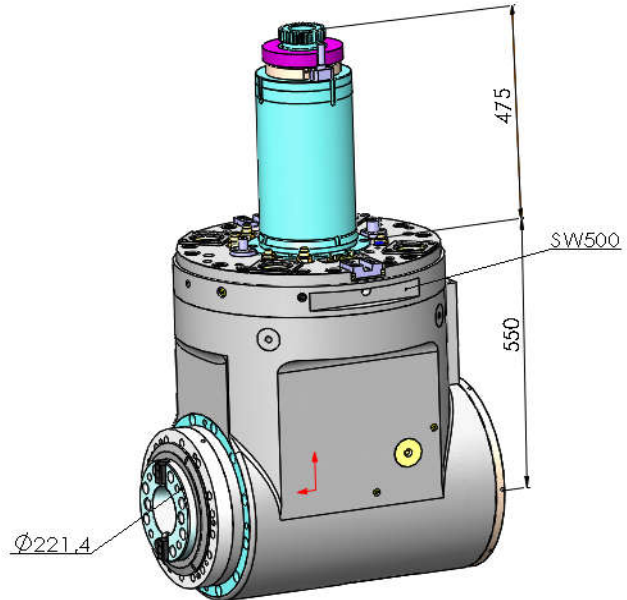

|                                     |                        |
|-------------------------------------|------------------------|
| GB 1 N                              |                        |
| Straight drilling- and milling head | S1 443 67              |
| <i>Gerader Bohr- und Fräskopf</i>   |                        |
| max. power on drive                 | 100 kW                 |
| <i>Max. Leistung (S1)</i>           |                        |
| max. spindle torque                 | 9000Nm                 |
| <i>Max. Spindeldrehmoment</i>       |                        |
| max. spindle speed                  | 2500 rpm               |
| <i>Max. Drehzahl</i>                |                        |
| tool clamping                       | automatic              |
| <i>Werkzeugspannung</i>             | <i>automatisch</i>     |
| possible tools                      | SK60                   |
| <i>Werkzeugaufnahme</i>             |                        |
| coolant supply                      | internal / external    |
| <i>Kühlmittelzufuhr</i>             | <i>innere / äußere</i> |

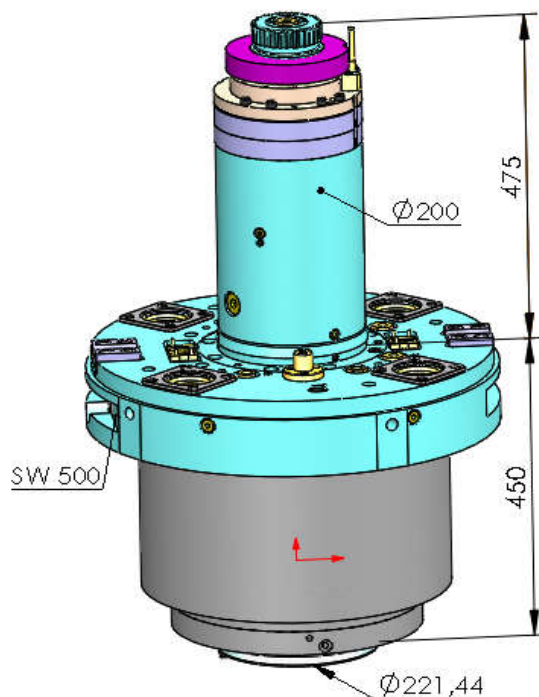



Support  $\varnothing 560 / 640 \times 570$

- tool adaption: 1x horizontal Capto C8
- Werkzeugaufnahme: 1x horizontal Capto C8

|                          |                        |
|--------------------------|------------------------|
| DMH                      |                        |
| Turning tool holder      | S3 261 57              |
| <i>Drehmeißelhalter</i>  |                        |
| -max. cutting force      | 55kN                   |
| <i>Max. Schnittkraft</i> |                        |
| tool clamping            | manual                 |
| <i>Werkzeugspannung</i>  | <i>manuell</i>         |
| coolant supply           | internal / external    |
| <i>Kühlmittelzufuhr</i>  | <i>innere / äußere</i> |

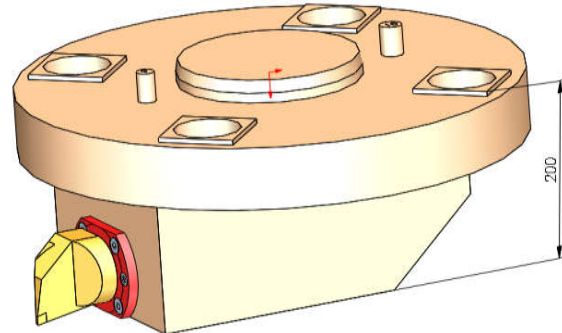

- tool adaption: 1x vertical / 1x horizontal Capto C8

|                          |                        |
|--------------------------|------------------------|
| DMH                      |                        |
| Turning tool holder      | S3 276 57              |
| <i>Drehmeißelhalter</i>  |                        |
| -max. cutting force      | 55kN                   |
| <i>Max. Schnittkraft</i> |                        |
| tool clamping            | manual                 |
| <i>Werkzeugspannung</i>  | <i>manuell</i>         |
| coolant supply           | internal / external    |
| <i>Kühlmittelzufuhr</i>  | <i>innere / äußere</i> |

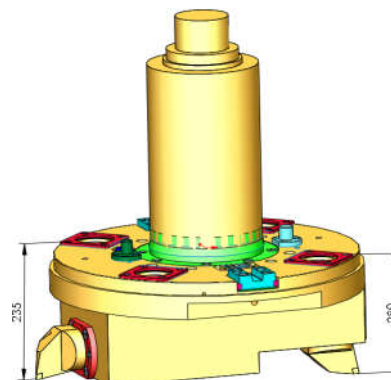

Support  $\varnothing 560 / 640 \times 570$

|                                     |                     |
|-------------------------------------|---------------------|
| GB 1 X N                            |                     |
| Straight drilling- and milling head | S1 481 67           |
| <b>Gerader Bohr- und Fräskopf</b>   |                     |
| max. power on drive                 | 60 kW               |
| Max. Leistung (S1)                  |                     |
| max. spindle torque                 | 5000Nm              |
| Max. Spindeldrehmoment              |                     |
| max. spindle speed                  | 2500 rpm            |
| Max. Drehzahl                       |                     |
| tool clamping                       | automatic           |
| Werkzeugspannung                    | automatisch         |
| possible tools                      | SK60                |
| Werkzeugaufnahme                    |                     |
| coolant supply                      | internal / external |
| Kühlmittelzufuhr                    | innere / äußere     |

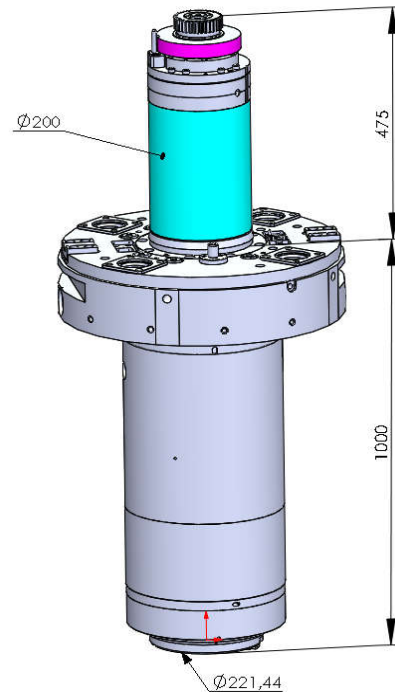

|                                      |                     |
|--------------------------------------|---------------------|
| UB 1 N                               |                     |
| Universal drilling- and milling head | S1 513 67           |
| <b>Universal-Bohr- und Fräskopf</b>  |                     |
| max. power on drive                  | 60 kW               |
| Max. Leistung (S1)                   |                     |
| max. spindle torque                  | 3000Nm              |
| Max. Spindeldrehmoment               |                     |
| max. spindle speed                   | 2500 rpm            |
| Max. Drehzahl                        |                     |
| tool clamping                        | automatic           |
| Werkzeugspannung                     | automatisch         |
| possible tools                       | SK60                |
| Werkzeugaufnahme                     |                     |
| coolant supply                       | internal / external |
| Kühlmittelzufuhr                     | innere / äußere     |

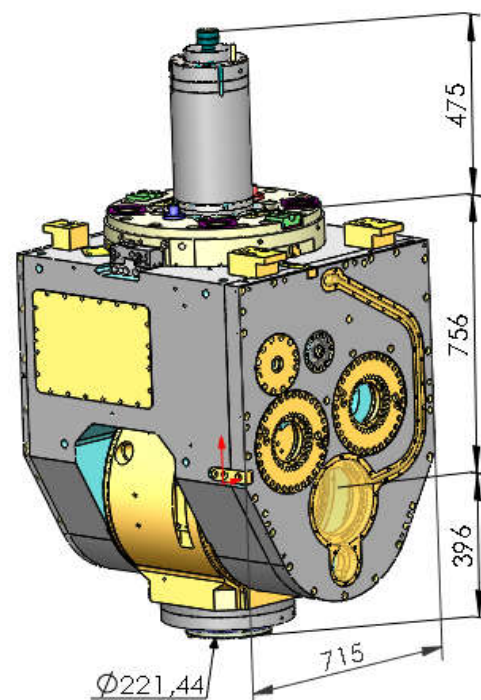

Support  $\varnothing 560 / 640 \times 570$

-tool adaption: 1x vertical Capto C8

-Werkzeugaufnahme: 1x vertikal Capto C8

|                          |                        |
|--------------------------|------------------------|
| DMH                      |                        |
| Turning tool holder      | S3 262 57              |
| <i>Drehmeißelhalter</i>  |                        |
| -max. cutting force      | 55kN                   |
| <i>Max. Schnittkraft</i> |                        |
| tool clamping            | manual                 |
| <i>Werkzeugspannung</i>  | <i>manuell</i>         |
| coolant supply           | internal / external    |
| <i>Kühlmittelzufuhr</i>  | <i>innere / äußere</i> |

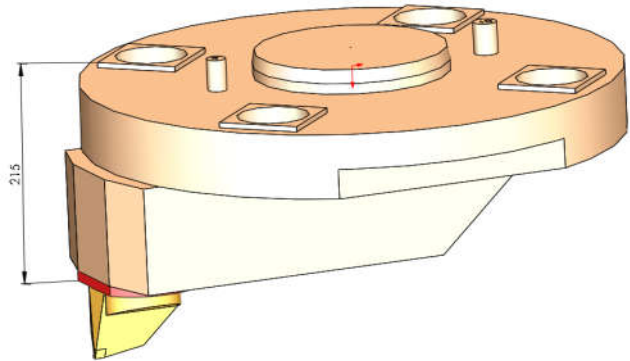

|                          |                |
|--------------------------|----------------|
| NSH                      |                |
| Standard tool holder     | S3 177 07      |
| <i>Normalstahlhalter</i> |                |
| max. cutting force       | 80kN           |
| <i>Max. Schnittkraft</i> |                |
| tool clamping            | manual         |
| <i>Werkzeugspannung</i>  | <i>manuell</i> |
| coolant supply           | external       |
| <i>Kühlmittelzufuhr</i>  | <i>äußere</i>  |

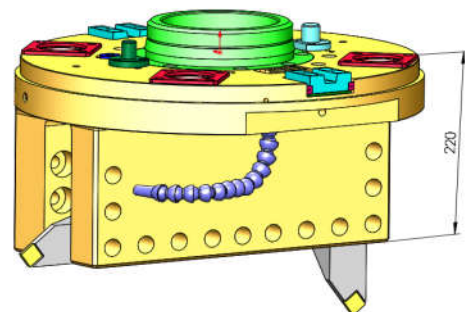

|  |                |
|--|----------------|
| <b>GB 1 XX N</b>                           |                |
| <b>Straight drilling- and milling head</b> | S1 429 17      |
| <b>Gerader Bohr- und Fräskopf</b>          |                |
| max. power on drive                        | 30 kW          |
| <i>Max. Leistung (S1)</i>                  |                |
| max. spindle torque                        | 1600Nm         |
| <i>Max. Spindeldrehmoment</i>              |                |
| max. spindle speed                         | 1000 rpm       |
| <i>Max. Drehzahl</i>                       |                |
| tool clamping                              | manual         |
| <i>Werkzeugspannung</i>                    | <i>manuell</i> |
| possible tools                             | SK50           |
| <i>Werkzeugaufnahme</i>                    |                |
| coolant supply                             | external       |
| <i>Kühlmittelzufuhr</i>                    | <i>äußere</i>  |

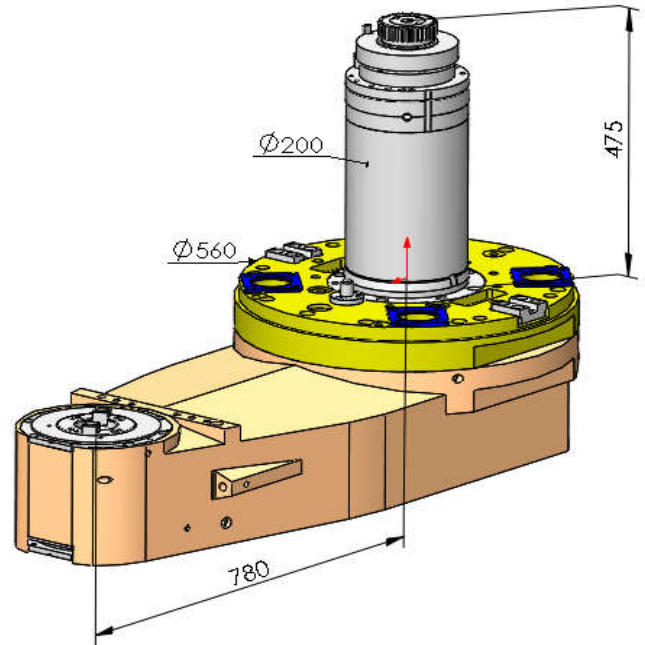

|   |                        |
|---|------------------------|
| <b>UB 1 XN</b>                              |                        |
| <b>universal drilling- and milling head</b> | S1 701 17              |
| <b>Universal drilling- and milling head</b> |                        |
| max. power on drive                         | 60 kW                  |
| <i>Max. Leistung (S1)</i>                   |                        |
| max. spindle torque                         | 2000Nm                 |
| <i>Max. Spindeldrehmoment</i>               |                        |
| max. spindle speed                          | 2500 rpm               |
| <i>Max. Drehzahl</i>                        |                        |
| tool clamping                               | automatic              |
| <i>Werkzeugspannung</i>                     | <i>manuell</i>         |
| possible tools                              | SK50                   |
| <i>Werkzeugaufnahme</i>                     |                        |
| coolant supply                              | internal / external    |
| <i>Kühlmittelzufuhr</i>                     | <i>innere / äußere</i> |

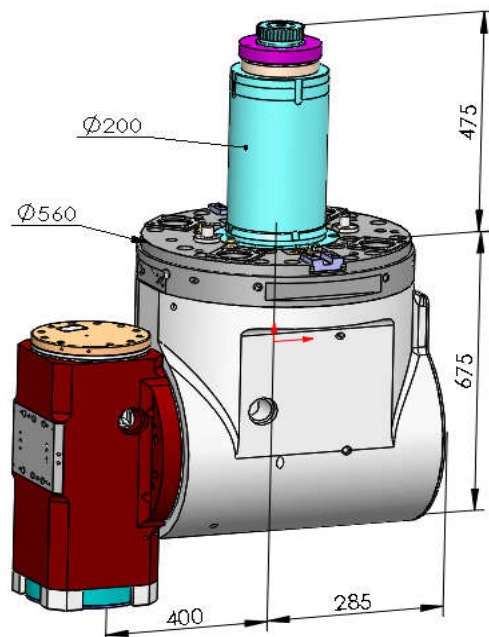

|  |                |
|--|----------------|
| <b>GPD</b>                             |                |
| <b>Straight facing and boring head</b> | S1 350 07      |
| <b>Gerader Plandrehkopf</b>            |                |
| max. power on drive                    | 100 kW         |
| <i>Max. Leistung (S1)</i>              |                |
| max. spindle torque                    | 8000Nm         |
| <i>Max. Spindeldrehmoment</i>          |                |
| max. spindle speed                     | 250 rpm        |
| <i>Max. Drehzahl</i>                   |                |
| tool clamping                          | manual         |
| <i>Werkzeugspannung</i>                | <i>manuell</i> |
| possible tools                         | D' Andrea      |
| <i>Werkzeugaufnahme</i>                |                |
| coolant supply                         | internal       |
| <i>Kühlmittelezufuhr</i>               | <i>innere</i>  |

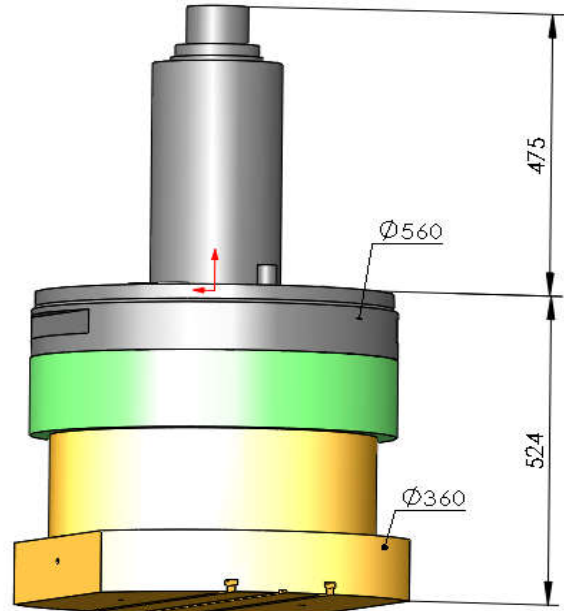

|                                       |                |
|---------------------------------------|----------------|
| <b>WPD</b>                            |                |
| <b>Angular facing and boring head</b> | S1 620 07      |
| <b>Winkel-Plan- und Ausdrehkopf</b>   |                |
| max. power on drive                   | 65 kW          |
| <i>Max. Leistung (S1)</i>             |                |
| max. spindle torque                   | 6000Nm         |
| <i>Max. Spindeldrehmoment</i>         |                |
| max. spindle speed                    | 315 rpm        |
| <i>Max. Drehzahl</i>                  |                |
| tool clamping                         | manual         |
| <i>Werkzeugspannung</i>               | <i>manuell</i> |
| possible tools                        | D' Andrea      |
| <i>Werkzeugaufnahme</i>               |                |
| coolant supply                        | internal       |
| <i>Kühlmittelezufuhr</i>              | <i>innere</i>  |

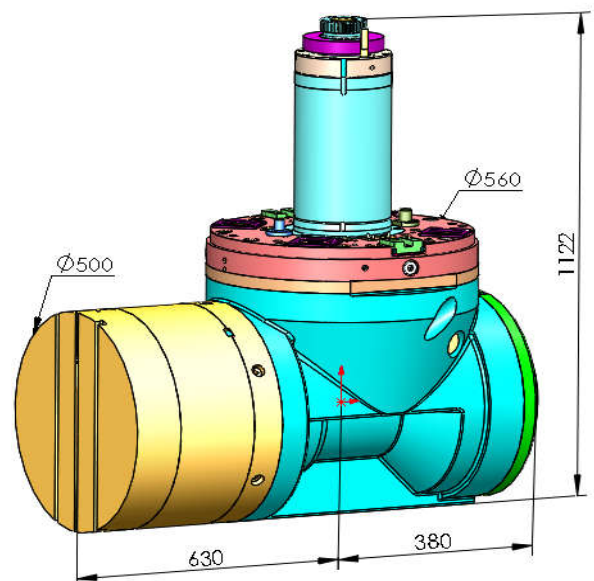

|                               |                          |
|-------------------------------|--------------------------|
| RH 60/50 (176 lang)           |                          |
| Reduction sleeve              | S1 114 10                |
| <b>Reduzierhülse</b>          |                          |
| max. spindle torque           | 3000Nm                   |
| <i>Max. Spindeldrehmoment</i> |                          |
| max. spindle speed            | dependent on head        |
| <i>Max. Drehzahl</i>          | <i>abhängig vom Kopf</i> |
| tool clamping                 | automatic                |
| <i>Werkzeugspannung</i>       | <i>automatisch</i>       |
| coolant supply                | internal                 |
| <i>Kühlmittelzufuhr</i>       | <i>innere</i>            |

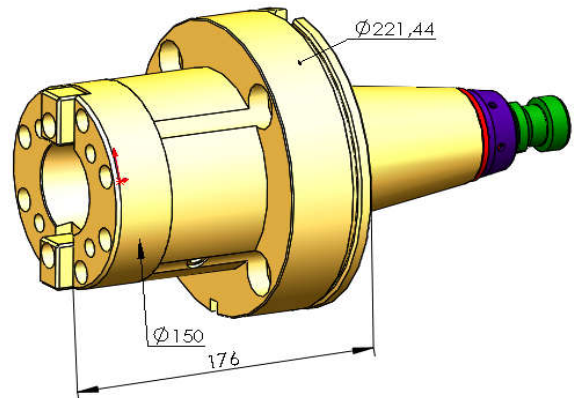

|                               |                    |
|-------------------------------|--------------------|
| RH 60/50 (500 lang)           |                    |
| reduction sleeve              | S1 151 10          |
| <b>Reduzierhülse</b>          |                    |
| max. spindle torque           | 3000Nm             |
| <i>Max. Spindeldrehmoment</i> |                    |
| max. spindle speed            | 1500 rpm           |
| <i>Max. Drehzahl</i>          |                    |
| tool clamping                 | automatic          |
| <i>Werkzeugspannung</i>       | <i>automatisch</i> |
| coolant supply                | internal           |
| <i>Kühlmittelzufuhr</i>       | <i>innere</i>      |

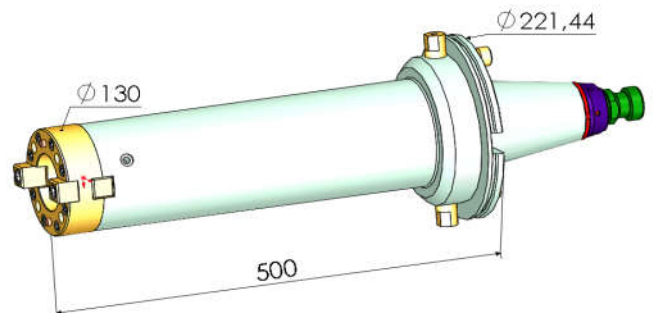

|                               |                    |
|-------------------------------|--------------------|
| <b>RH 60/50 N (1000 lang)</b> |                    |
| <b>Reduction sleeve</b>       | S1 456 10          |
| <b>Reduzierhülse</b>          |                    |
| max. spindle torque           | 3000Nm             |
| <i>Max. Spindeldrehmoment</i> |                    |
| max. spindle speed            | 500 rpm            |
| <i>Max. Drehzahl</i>          |                    |
| tool clamping                 | automatic          |
| <i>Werkzeugspannung</i>       | <i>automatisch</i> |
| coolant supply                | internal           |
| <i>Kühlmittelzufuhr</i>       | <i>innere</i>      |

